

PF15 DIMENSION

TWO OFF MOUNTING HOLES, 5.5mm DIM.

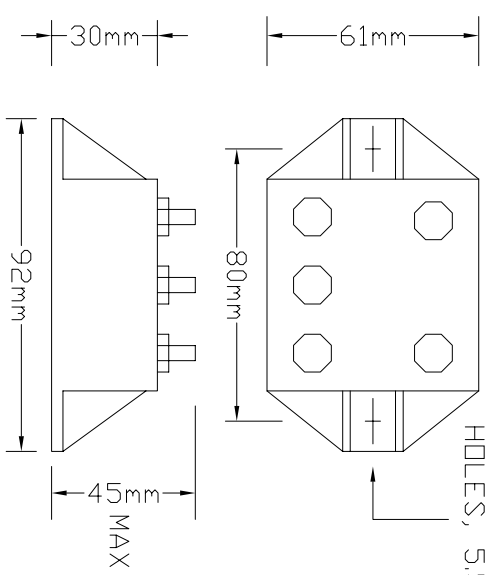

PF 15A RFI FILTER

The max. supply voltage for a PF15A is 264V_{ac}, max. current is 15A at 40 degree C ambient.

When a phase angle controller is used together with a PF15A, the electrical noise produced will be reduce to a level which meet the EMC requirement, EMC generic standard, EN50081.

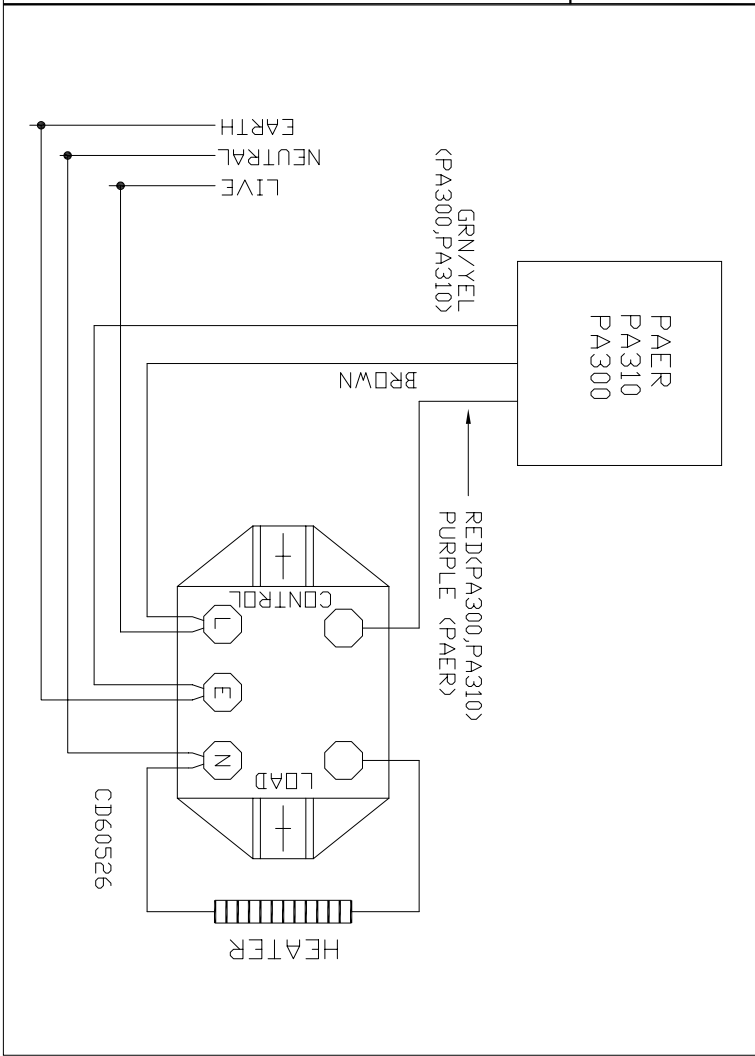
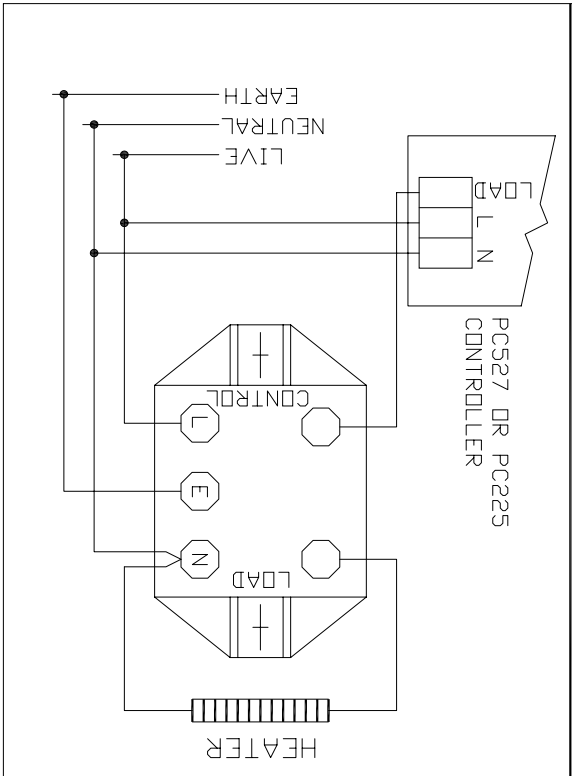

POWERLINK ELECTRONICS LTD.

ISSUE	AMENDMENT	MADE BY	DATE	DESIGNED BY	DATE	CLIENT	TITLE
				DRAWN BY	JULY 2002		PF15A WIRING DIAGRAM
				CHECKED BY		PROJECT No:	
				APPROVED BY			DRAWING No: CD60526B
				SCALE:		SHEET :	A3
							R